

ZEDTurn+

*Most Productive Turning Solution
for **ZERO DEFECT** Production*

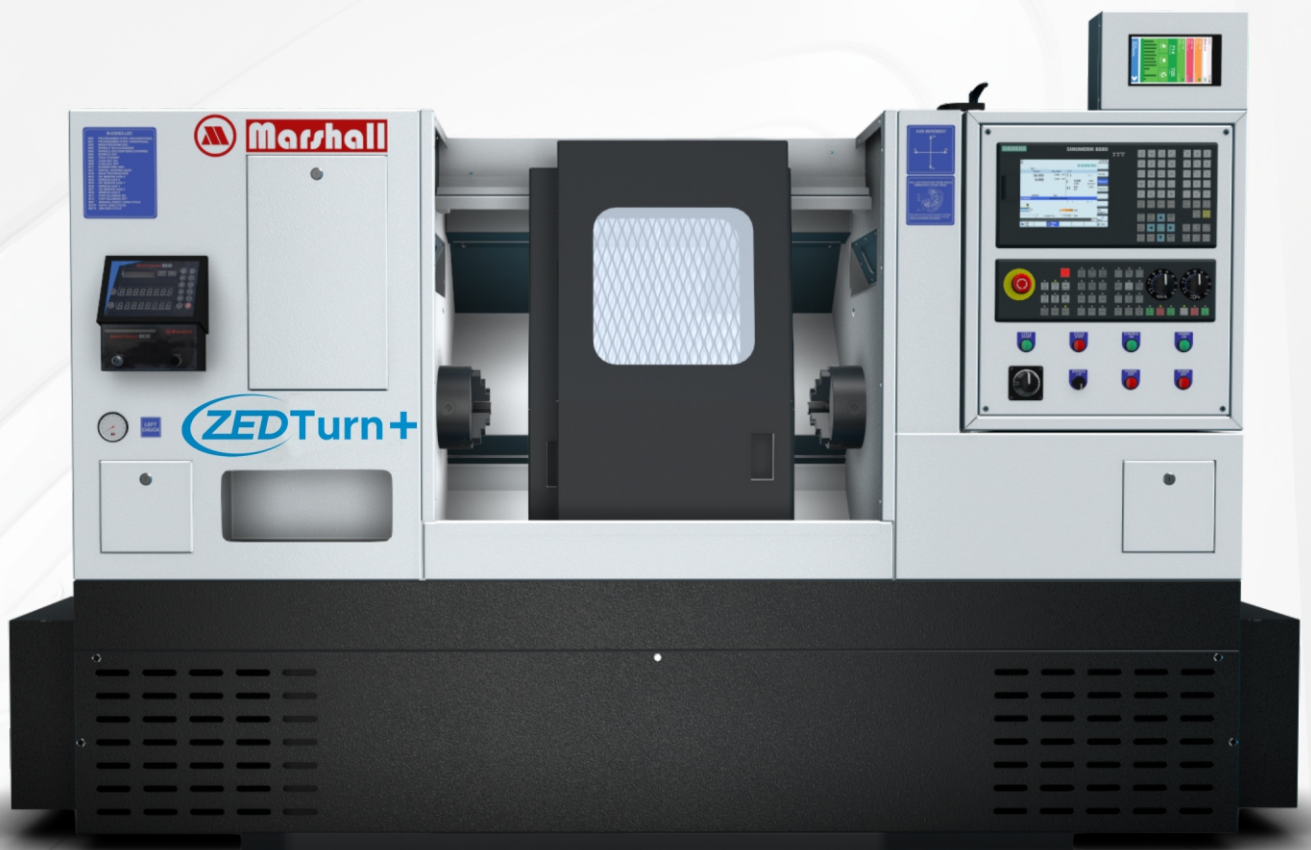

*Perfect Turning Solution
for Bearing Rings up to 70mm*



Advantage #1 HIGHEST PRODUCTIVITY

- No IDLE TIME resulting in higher productivity.
- WHILE MACHINING is going on at one head, the operator unloads completed job and clamps fresh job at second head.
- TWO SET UPS available on one machine one half of the job can be completed on one spindle while the second half be completed on other spindle.
- ONLY ONE OPERATOR required & space taken is similar to be one machine.
- LINEAR TOOLING SYSTEM used on “MARSHALL” Double SPINDLE MACHINES reduces machining time because of faster positioning of tools compared to tool turret.



Advantage #2

SAVING IN SPACE + COMFORT FOR OPERATOR

COMPARISON BETWEEN ZEDturn (DOUBLE SPINDLE) AND SINGLE SPINDLE MACHINES

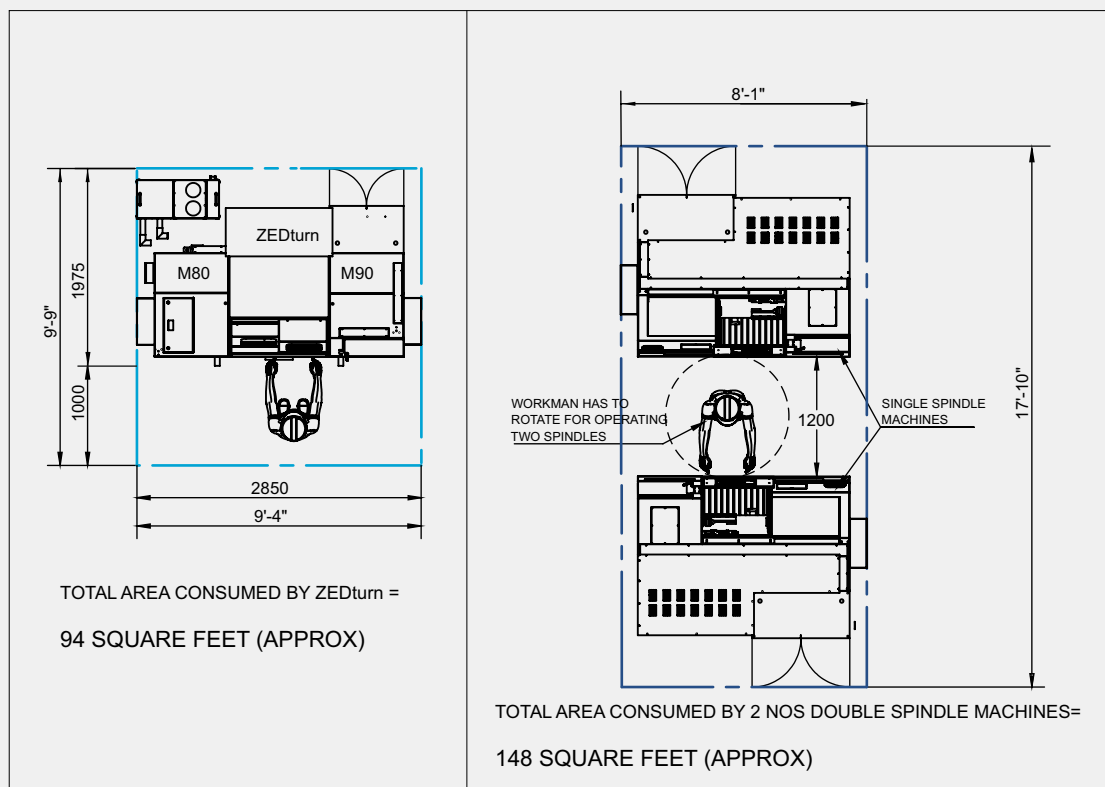

Advantage #3 NO NEED FOR SKILLED OPERATOR



Marshall's *SmartCorrect* ECO Gauging

Station is Pre-Fitted on *ZEDturn* and it measures & auto-corrects up to 4 dimensions.

Eg. In case of Inner Ring of Ball Bearing

1. Bore
2. Width
3. Track Size
4. Track Centering.

SmartCorrect ECO

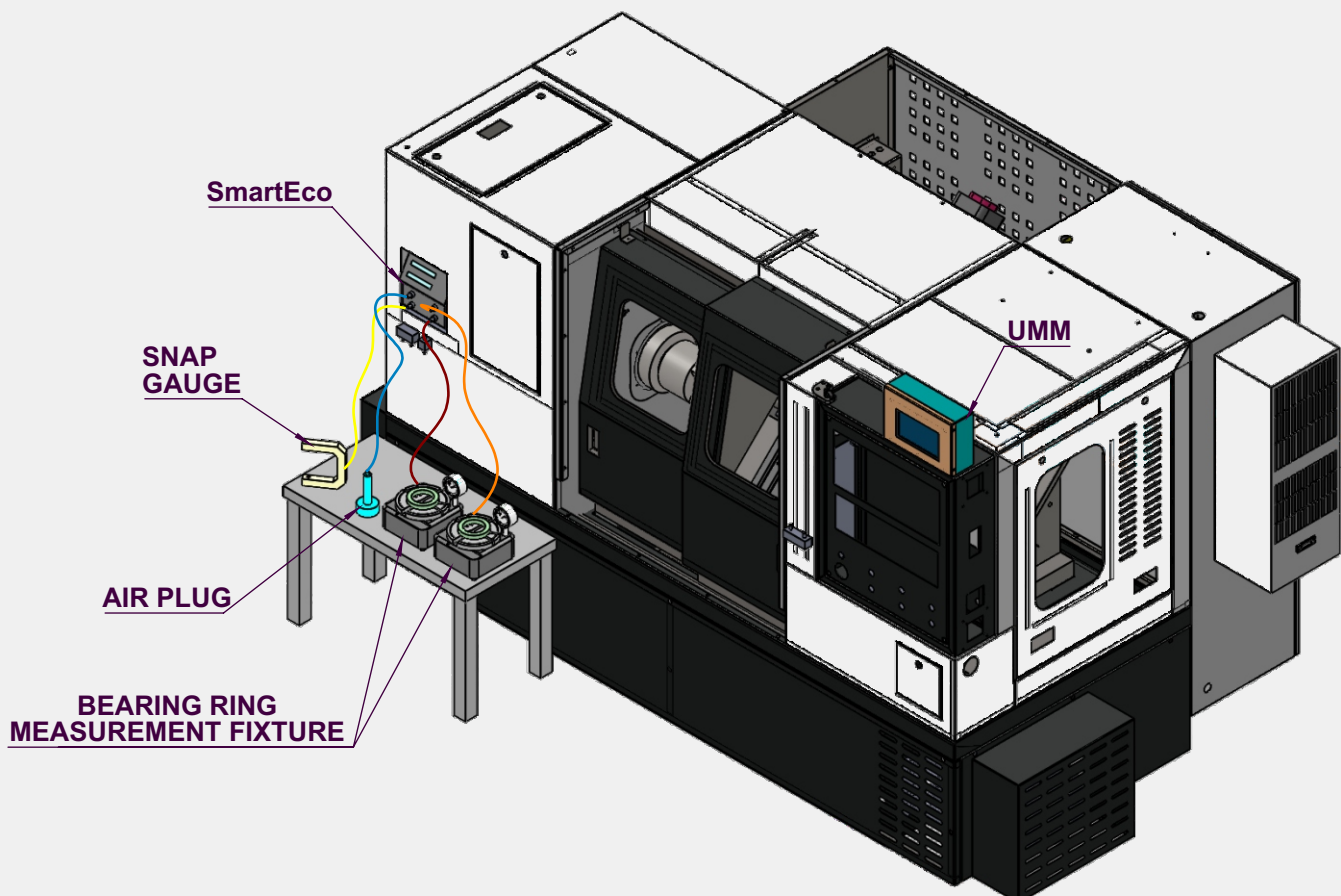

Advantage #4 ZERO DEFECT PRODUCTION with CLAP

Marshall's Patented CLAP (Closed Loop Auto-Corrected Production) Technology ensures that Gauging Station Constantly maintains turned dimensions close to mean value thereby ensuring ZERO DEFECTS without Skilled Manpower or Quality Inspectors.

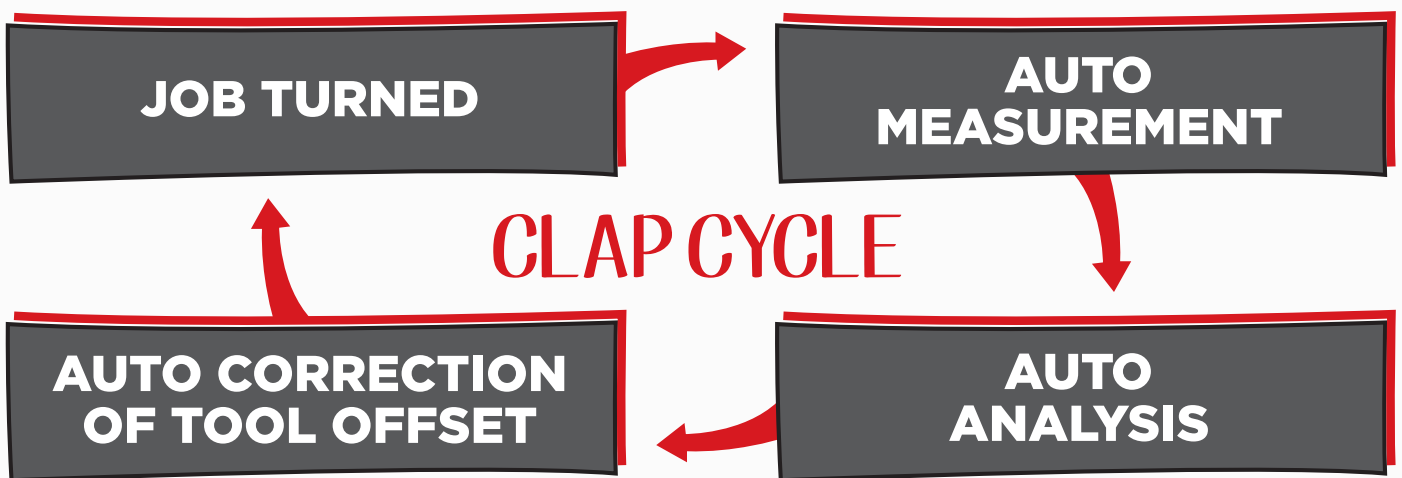

The advanced ALGORITHMS in **SmartCorrect** software calculate **and automatically correct** tool wear offsets to keep size close to the mean of tolerance **limit**.

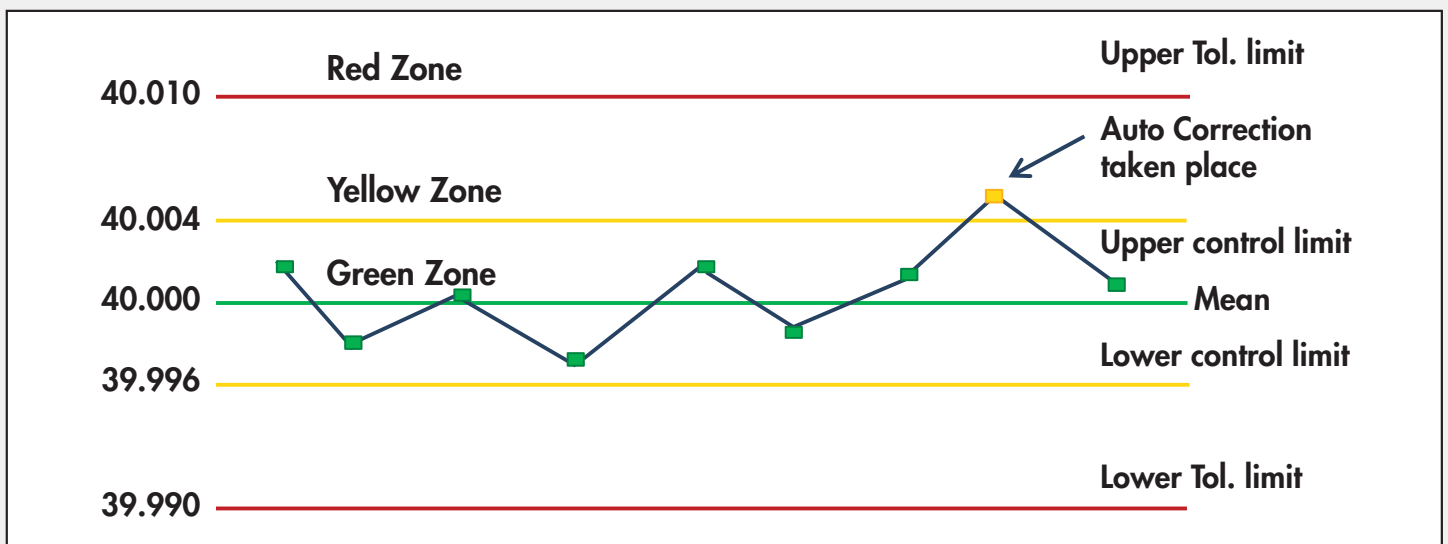

Specifications

Model	ZEDTurn +
CAPACITY	
Swing Over Bed (mm)	310
Maximum Turning Dia. (mm)	135
Maximum Turning Length (mm)	100
X-Axis Stroke (mm)	350
MAIN SPINDLE	
Spindle Nose (Standard)	A2-5
Front Bearing Bore (mm)	85
Maximum Bar Capacity (Std.) (mm)	38
SPINDLE DRIVE	
Spindle Motor rated power (KW) Fanuc Siemens	5.5/7.5
Inf. Variable speed range (rpm)	100-4500
RAPID TRAVERSE	
STANDARD	
X-axis (m/min.)	24
Z-axis (m/min.)	24
POSITIONING REPEATABILITY	
X-axis	± 1.5 Microns
Z-axis	± 2 Microns
CNC Controls:	SIEMENS 808D
Weight (approx.) (Kg)	4000

Note : Product improvement is a continuous process at "Marshall".
Design & Specifications are therefore, subject to change, without prior notice.

Factories & Works:



Headoffice & Works
(Ludhiana, India)



Automation Unit
(Ludhiana, India)



Industry 4.0 center
(Delhi, India)



Tech Center
(Atlanta, USA)



Marshall Automation America. Inc.

Smart CNC Automation & Gauging Solutions

Regd. Office

Suite#23, 2885, North Berkeley Lake Road, NW,
Duluth, GEORGIA 30096 (USA)
Phone: 404-394-6678

ani@marshallautomationamerica.com
www.marshallautomationamerica.com



Marshall Machines Ltd.

Head Office & Works

C 86, Phase-V, Focal Point, Ludhiana 141 010
Phone: +91 161 5012406, 5012407

National Sales, Services & Technology Center

75-B, Sector 5, IMT Manesar, Distt. Gurgaon
Phone: +91-0124-4241813 | Cell: +91-96502 93944

Automated Solutions Division (Unit II)

D-116A, Ph.-V, Focal Point, Ludhiana-141010

headoffice@marshallcnc.com
www.marshallcnc.com