



Marshall

TWINTURN UBER



uber-

/ˈuːbəl/

(adj.):

a person or thing that exceeds the norms or limits of its kind or class

THE Machine for super-optimized Turning

- 60 Degree Slant Bed
- Monoblock casting with 'Harcrete'
- 5500 Rpm & 30m/min. Rapids
- Upto 8 tools per spindle with option of through coolant in selected block.

Design Registered by Patent Office of India

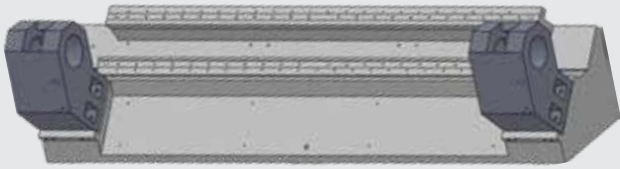

**Upto
8 Tools
per
spindle**

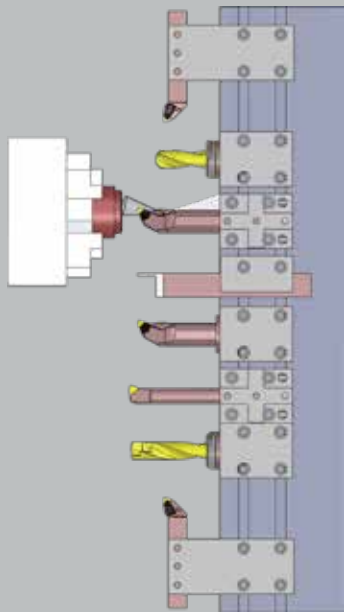

MOST COMPACT FOOT PRINT
(600 mm less than Twinturn 6L)



Twinturn 6L

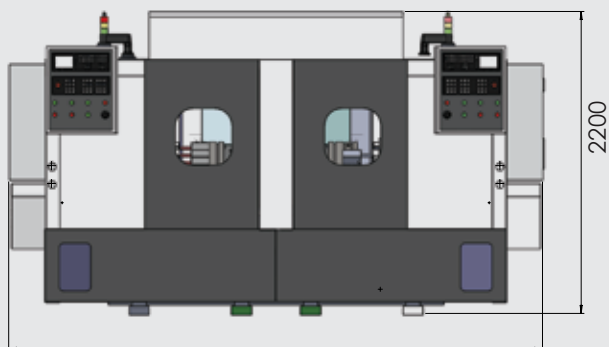

Twinturn UBER 3700

Twinturn UBER

has the highest specifications, features & performance among CNC chuckers.

CAPACITY

Swing Over Carriage Cover (mm)	360
Maximum Turning Dia. (mm)	250
Maximum Turning Length (mm)	200
Maximum Boring Length (mm)	150

MAIN SPINDLE

Spindle Nose (Standard)	A2-5
Front Bearing Bore (mm)	85
Maximum Bar Capacity (Std.) (mm)	40

SPINDLE DRIVE

Spindle Motor rated power (KW)	7.5/11
Inf. Variable speed range (Std.) (rpm)	100-4500
Inf. Variable speed range (Opt.) (rpm)	100-5500

LINEAR SLIDE

X-axis Stroke (mm)	500
Maximum No. of tools /side	8
Tool Shank Size	25x25
Maximum Tool Bore Size (mm)	40

RAPID TRAVERSE

STANDARD	
X-axis (m/min.)	30
Z-axis (m/min.)	30

POSITIONING REPEATABILITY

X-axis	± 1.5 microns
Z-axis	± 2.0 microns

CNC Controls: SIEMENS 808D / 828D / FANUC 0iTf

Weight (approx.) (Kg) 4500

Note : Product improvement is a continuous process at "Marshall".
Design & Specifications are therefore, subject to change



Marshall Machines (P) Ltd.

Head Office & Works

C 86, Phase-V, Focal Point, Ludhiana 141 010
Phone: +91 161 5012406, 5012407, 5019648

National Sales, Services & Technology Center

75-B, Sector 5, IMT Manesar, Distt. Curgaon
Phone: +91-0124-4241813-15 | Cell: +91-96502 93942

Automated Solutions Division (Unit II)

D-116A, Ph.-V, Focal Point, Ludhiana-141010

headoffice@marshallcnc.com | cncsales@marshallcnc.com
marshallcnc.com | marshallcnc.in | marshallautomation.in



Marshall Automation America, Inc.

Smart CNC Automation & Gauging Solutions

Regd. Office

415, Lakehill Court, Johns Creek, GEORGIA 30022 (USA)
Phone: 404-394-6678

info@marshallautomationamerica.com
marshallautomationamerica.com